

# TECHNICAL DATASHEET

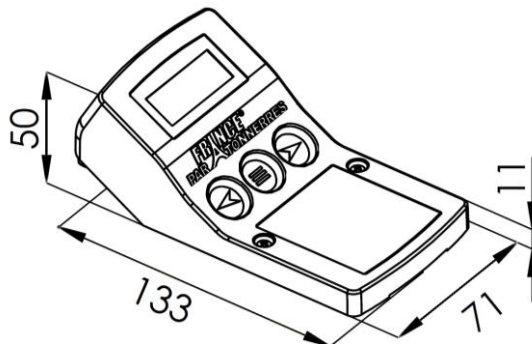

## CHARACTERISTICS

Reference	30 004
Designation	<b>IFLASH REPORT®</b>
Technology	Electronics with Bluetooth® connexion
Operation	The electronic counter is activated by the radiated magnetic fields
Range of detection	1 kA – 100 kA
Recording	Up to 100 events (date, hour and intensity of the current)
Lifetime of the battery	In normal use, with display one time per quarter, lifetime is between 2 and 3 years. With a more frequent use, lifetime can be lower. In this context, it can be necessary to change the battery.
Power supply	Battery 3,6 V (Lithium)
Protection index	IP67
Range of temperature	-25°C to +70°C
Weight	200 g
Dimensions	133 x 71 x 50 mm



**Qualifoudre**  
INERIS  
N° 051168729019



CONFORM TO  
NF EN 62 561-6

## INSTALLATION

Fixing in parallel	Continuity of the down conductor
Connection	Directly on the down conductor (Ø 8 to 10mm for round conductor, 30x2mm or 30x3mm for flat conductor)
Size	Discrete integration on down conductor
Robustness and reliability	High resistance to extreme climatic conditions (rain, sun, freeze...)

## HOMOLOGATIONS AND STANDARDS

NF EN 62 561-6	Components of the lightning protection devices Part 6 : requirements for lightning counters
Test in COFRAC laboratory	Guaranted up to 100kA for negative and positive lightning impacts

## WORKING

- The IFLASH REPORT® registers the lightning events (date and hour) and measures the intensity of the current (memory : 100 events).
- Data available directly on LCD screen of the counter or with Smartphone via Bluetooth® connexion (up to 25m).
- Visual warning when the maintenance date of the lightning protection installation is exceeded
- Self-test mode for the checking of the functions of the counter and battery status
- 1 year guarantee

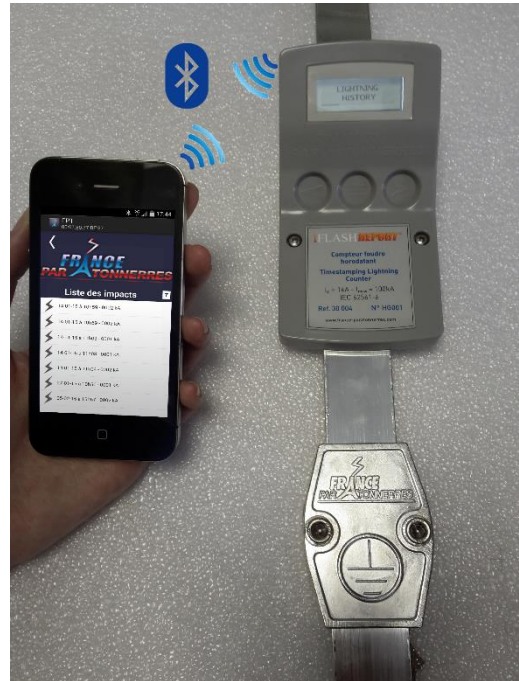

## OUTDOOR INSTALLATION

Easy installation of the counter directly on all down conductors (round conductor Ø 8mm and flat conductor 30x2mm).

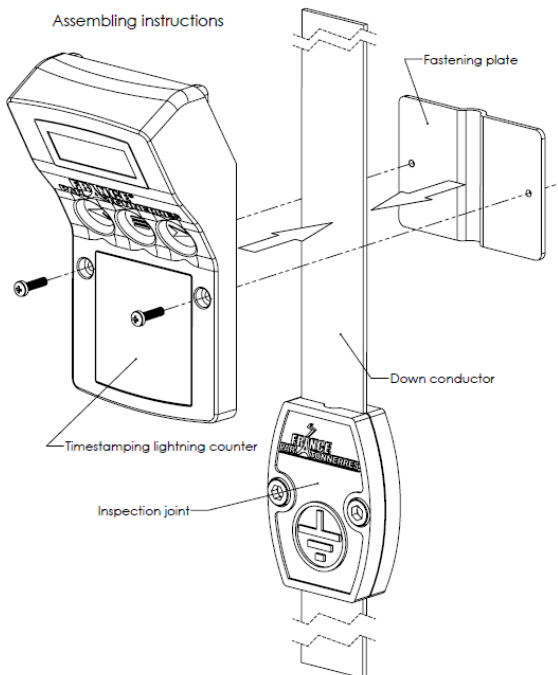

## INDOOR INSTALLATION

Installation of the counter on the earthing conductors of surge arresters in electrical installation (whatever the section is).

