

## Our products / Protection against direct effects of lightning

### > Conductors fixings >

#### ■ Clamps for roof

Fixing of down-conductors on all types of roof.

[ Such as : tile, slate, stone,....

##### • 14034/14000



Ref	Designation	Material	Length	Weight	To use with
14034	Fastening strap	Copper	100 mm	54 g	Plate or round conductor
14000	Rein for slate	Tinplated copper	200 mm	58 g	Plate conductor

#### ■ Straps ride

For fixing flat conductors. Protects the conductor against damage

##### • 14010/14009

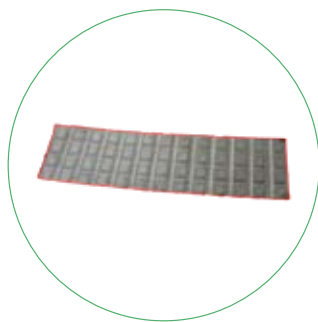

Ref	Designation	Matière	Dimensions	Poids	A utiliser avec
14010	Ruberalu	Ruberalu	170 x 45 mm	35 g	Rivets
14009	Riveted or welded strap	Tinplated Copper	60 x 12 mm	3g	14012 or 14013

Ref. 14034

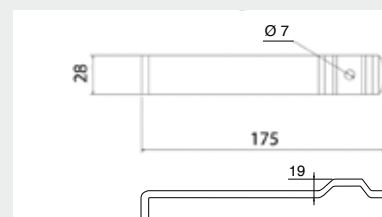

Ref. 14000

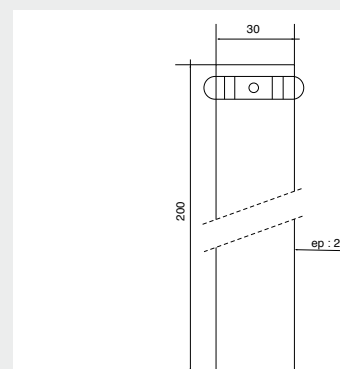

Ref. 14010

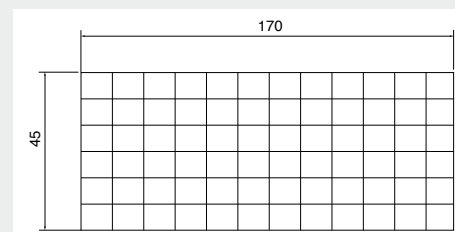

Ref. 14009

